

Bravera Bank NW Branch

1615 Burnt Boat Dr. - Bismarck, ND

1,949 sf - \$29.00 psf + \$5.50 psf CAM / \$5,604 mo.



Taylor Daniel | Vice President
Commercial Realtor®
Taylor@DanielCompanies.com

Bill Daniel | President
CCIM, Broker
Bill@DanielCompanies.com

DanielCompanies.com

Executive Summary for Lease

Address:	1615 Burnt Boat Dr. - Bismarck, ND
Date Available:	Available Now
Approximate SF:	1,949 sf
Lease Rate:	29.00 psf NNN / \$5,604 mo.
Estimated NNN:	\$5.50 psf
Lease Term:	10 Year Term
Parking:	Abundant On-Site

Broker does not guarantee the information describing this property. Interested parties are advised to independently verify the information through personal inspectors or with appropriate professionals.



Lease Price: \$29 psf NNN

- ♦ \$5.50 psf NNN
- ♦ Space Available: 1,949 sf
- ♦ \$20 psf TI Allowance after Warm Shell w/ 2 Restrooms
- ♦ Ample Front Door Parking
- ♦ High Traffic Area
- ♦ Great Visibility Corner
- ♦ Signage on 2 Sides of Building and Pylon!
- ♦ 10 Yr. Lease Term

Potential Uses:

- ♦ Food / Restaurant
- ♦ Medical
- ♦ Retail
- ♦ Spa
- ♦ Professional Office



Taylor Daniel | Vice President
Commercial Realtor®
Taylor@DanielCompanies.com

Bill Daniel | President
CCIM, Broker
Bill@DanielCompanies.com

DanielCompanies.com



VEHICLES PER DAY

33,129



	1 MILES	3 MILES	5 MILES
	6,154	53,235	99,697
2020 POPULATION			
	6,094	63,506	105,963
DAYTIME POPULATION			
	294	3,153	5,101
BUSINESSES			
	3,825	46,065	70,730
EMPLOYEES			
	\$100,094	\$84,705	\$84,512
HOUSEHOLD INCOME			



Taylor Daniel | Vice President
Commercial Realtor®
Taylor@DanielCompanies.com

Bill Daniel | President
CCIM, Broker
Bill@DanielCompanies.com

DanielCompanies.com

Site Plan

 - Great Signage for Tenant!

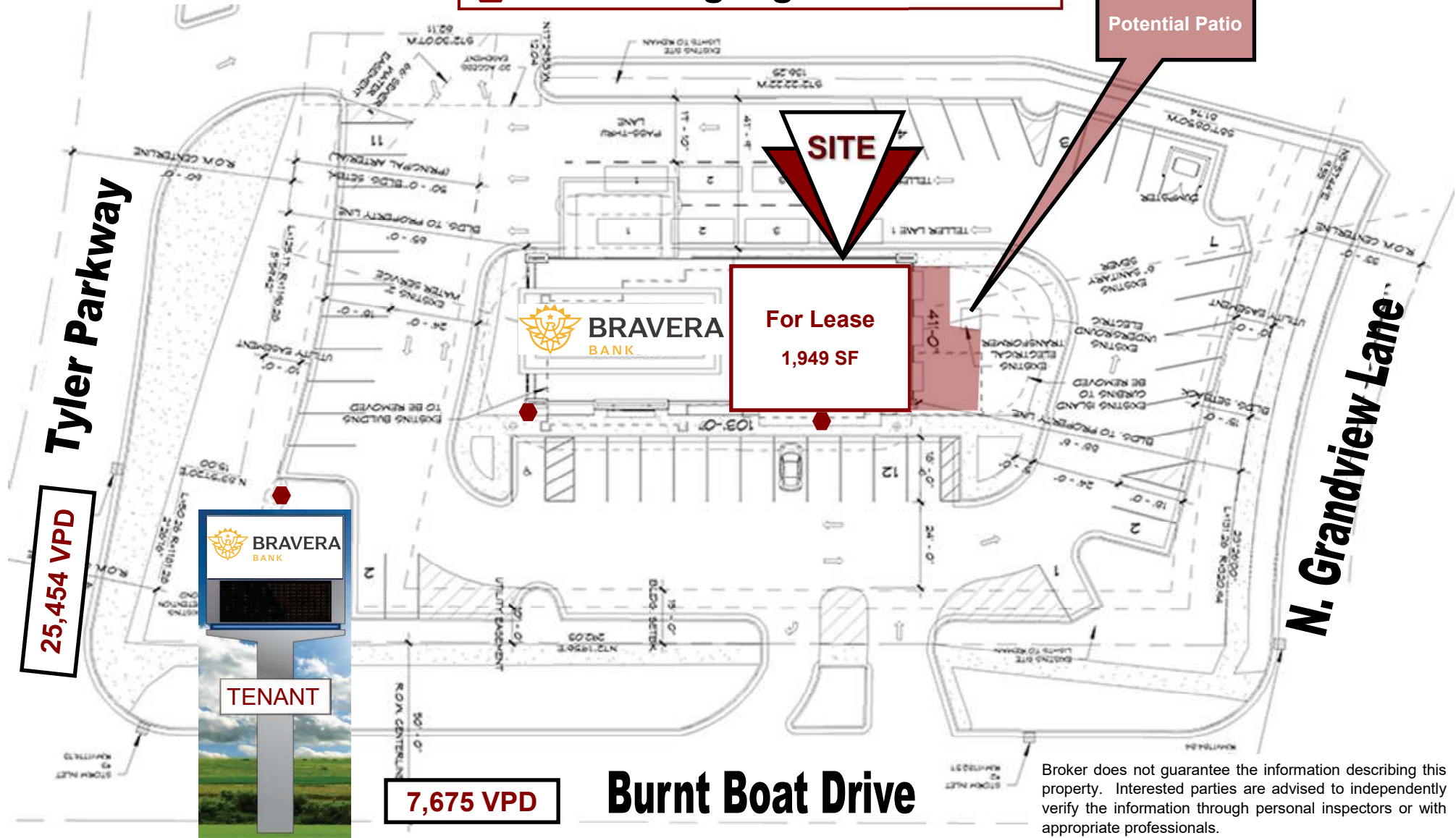

Broker does not guarantee the information describing this property. Interested parties are advised to independently verify the information through personal inspectors or with appropriate professionals.

**Great Pylon
Signage Visibility
In front of
33,000+ VPD!**

**Potential For
Outdoor Patio Area!**



Taylor Daniel | Vice President
Commercial Realtor®
Taylor@DanielCompanies.com

Bill Daniel | President
CCIM, Broker
Bill@DanielCompanies.com

DanielCompanies.com

Mandan, ND

INTERSTATE
94

SITE

Exit 159

Divide Ave

Tyler Pkwy

Century Ave

Country West Rd

MDU RESOURCES
COMMUNITY BOWL

LOWE'S

DOLLAR TREE

PETSMART

BEST BUY

KOHL'S

OLD NAVY

TJ-MAXX

TOUCHMARK

MDU RESOURCES





DANIEL COMPANIES

The Leader in Commercial Real Estate



**Bill Daniel, CCIM | President
Commercial Broker**

701.220.2455

Bill@DanielCompanies.com



**Taylor Daniel | Vice President
Commercial Realtor®**

701.391.4262

Taylor@DanielCompanies.com

Serving commercial real estate clients with unmatched market knowledge, experience and a well-deserved reputation for integrity.
They know the Bismarck-Mandan commercial real estate market better than anyone.

Powerful Team. Powerful Process. Powerful Results.