

# Office / Warehouse

1926 Frontier Dr.

Bismarck, ND



**Kyle Holwagner, CCIM, SIOR**

701.400.5373

[Kyle@DanielCompanies.com](mailto:Kyle@DanielCompanies.com)

**Kristyn Steckler, Market Coordinator**

701.527.0138

[Kristyn@DanielCompanies.com](mailto:Kristyn@DanielCompanies.com)

[DanielCompanies.com](http://DanielCompanies.com)

## Lease: \$7.75 to \$10 psf NNN

- 10,640 sf Available
- 7 Private Offices w/ Lobby
- Break Room w/ Kitchenette
- Copier / Office Equipment Room
- Office fan forced heating & cooling
- Radiant heat warehouse
- (2) 14' x 14' Overhead Doors
- Floor drains
- Warehouse area 15' side wall; 20' center ceiling height
- Fully liner panel warehouse
- Excellent lighting
- Walk-In warehouse doors
- Ample parking
- West side fenced storage
- Easy access to Airport Road and Bismarck Expressway

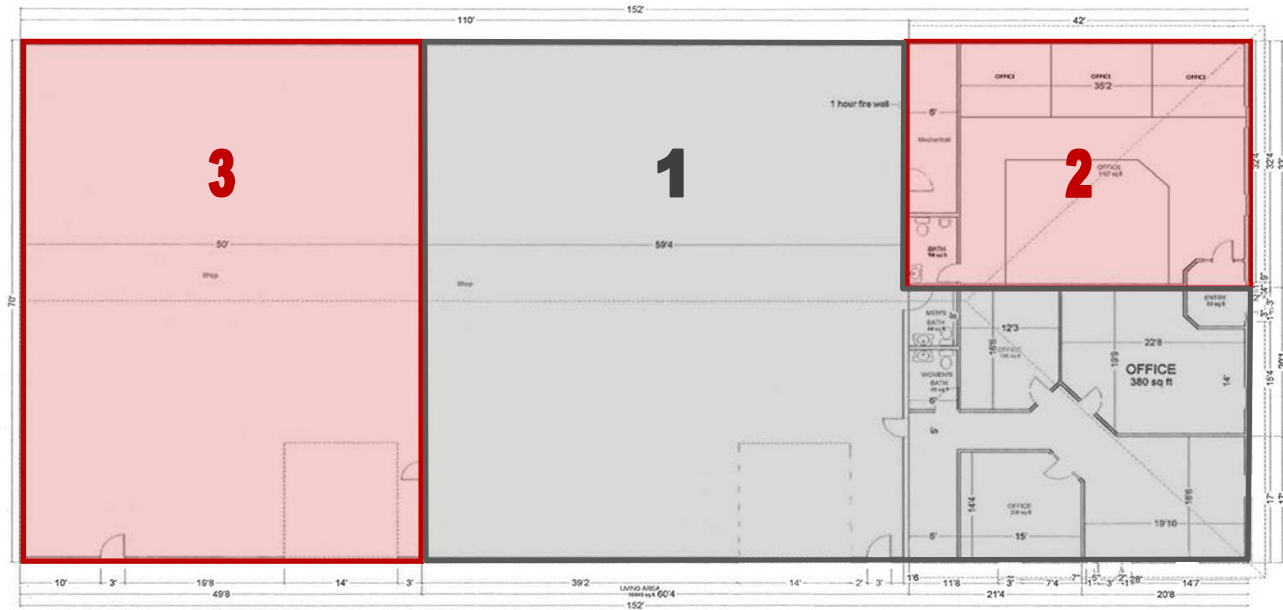

Space 3: 3,500 sf @ \$7.75 psf (\$2,260.42 / mo)

Space 1: 5,754 sf @ \$8.75 psf (\$4,195.63 / mo)

Space 2: 1,386 sf @ \$10.00 psf (\$1,155.00 / mo)



Kyle Holwagner, CCIM, SIOR

701.400.5373

[Kyle@DanielCompanies.com](mailto:Kyle@DanielCompanies.com)

Kristyn Steckler, Market Coordinator

701.527.0138

[Kristyn@DanielCompanies.com](mailto:Kristyn@DanielCompanies.com)

[DanielCompanies.com](http://DanielCompanies.com)



**SITE**

1126 Frontier Drive



**Kyle Holwagner, CCIM, SIOR**  
 701.400.5373  
[Kyle@DanielCompanies.com](mailto:Kyle@DanielCompanies.com)

**Kristyn Steckler, Market Coordinator**  
 701.527.0138  
[Kristyn@DanielCompanies.com](mailto:Kristyn@DanielCompanies.com)

[DanielCompanies.com](http://DanielCompanies.com)



# DANIEL COMPANIES

The Leader in Commercial Real Estate

Serving commercial real estate clients with unmatched market knowledge, experience, and a well-deserved reputation for integrity. They know the Bismarck-Mandan commercial real estate market better than anyone. This powerful team delivers powerful results.



**Bill Daniel, CCIM, Broker**  
701.220.2455  
Bill@DanielCompanies.com



**Kyle Holwagner, CCIM, SIOR**  
701.400.5373  
Kyle@DanielCompanies.com



**Taylor Daniel, Commercial REALTOR®**  
701.391.4262  
Taylor@DanielCompanies.com

701.223.8488  
304 E ROSSER AVE #200  
BISMARCK, ND 58501



ICSC CCIM SIOR  
INDIVIDUAL MEMBERS

RETAIL • INVESTMENTS • OFFICE • INDUSTRIAL • SITE SELECTION • LEASING • BUILD TO SUIT • BROKERAGE