

Industrial Warehouse / Shop

1260 Hemlock St. - Bismarck, ND

\$699,900



Kyle Holwagner, CCIM, SIOR
701.400.5373
Kyle@DanielCompanies.com

Kristyn Steckler, Senior Client Coordinator
701.527.0138
Kristyn@DanielCompanies.com

DanielCompanies.com

Executive Summary for Sale

Parcel ID:	38-138-80-47-02-030
Address:	1260 Hemlock St - Bismarck, ND
Legal Description:	Addition Name: IGOE'S INDUSTRIAL #1 TWN: 138 RNG:80 BLK:02 IGOES'INDUSTRIAL #1 Block 02 Lots 3 & 4
Price:	\$699,900
Lot Size:	24,393.60
Gross Building Area:	12,000 sf: Office: 384 sf; Warehouse: 11,616 sf
Year Built:	1979
Zoning:	MA - Light Industrial
Taxes 2018:	\$2,774.85
Specials:	None at this time

Broker does not guarantee the information describing this property. Interested parties are advised to independently verify the information through personal inspectors or with appropriate professionals.

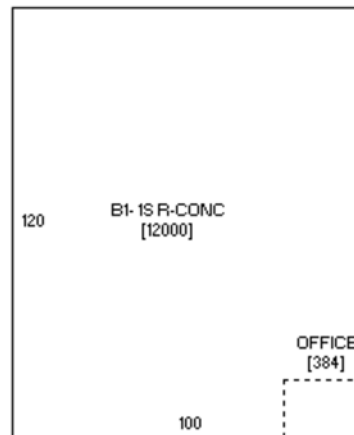

Sale: \$699,900

- CAP Rate 7.1%
- 18' Ceiling Height
- 14' x 14' Overhead Door
- 8' x 9' Dock Door
- Office with Restroom
- Floor Drain
- Well, Septic Tank
- Self Standing Building
- 3 Phase Power
- Natural Gas Unit Heater
- Common Wall



Kyle Holwagner, CCIM, SIOR
701.400.5373
Kyle@DanielCompanies.com

Kristyn Steckler, Senior Client Coordinator
701.527.0138
Kristyn@DanielCompanies.com



Kyle Holwagner, CCIM, SIOR
701.400.5373
Kyle@DanielCompanies.com

Kristyn Steckler, Senior Client Coordinator
701.527.0138
Kristyn@DanielCompanies.com

DanielCompanies.com



DANIEL COMPANIES

The Leader in Commercial Real Estate



Bill Daniel
CCIM, Broker

701.220.2455
Bill@DanielCompanies.com



Kyle Holwagner
CCIM, SIOR

701.400.5373
Kyle@DanielCompanies.com



Taylor Daniel
Commercial REALTOR®

701.391.4262
Taylor@DanielCompanies.com

Serving commercial real estate clients with unmatched market knowledge, experience and a well-deserved reputation for integrity. They know the Bismarck-Mandan commercial real estate market better than anyone.

Powerful Team. Powerful Process. Powerful Results.