

Prime Development Parcel

1825 Lee Ave & 1805 Park Ave - Bismarck, ND

Lot A: \$396,960

Lot B: \$222,468

Lee Ave.

Airport Rd.

Park Ave.

Lot A
1825 Lee Ave - 66,716 sf

Lot B
1805 Park Ave - 74,156 sf



Taylor Daniel, Commercial REALTOR®
701.391.4262
Taylor@DanielCompanies.com

Bill Daniel, CCIM, Broker
701.220.2455
Bill@DanielCompanies.com

DanielCompanies.com

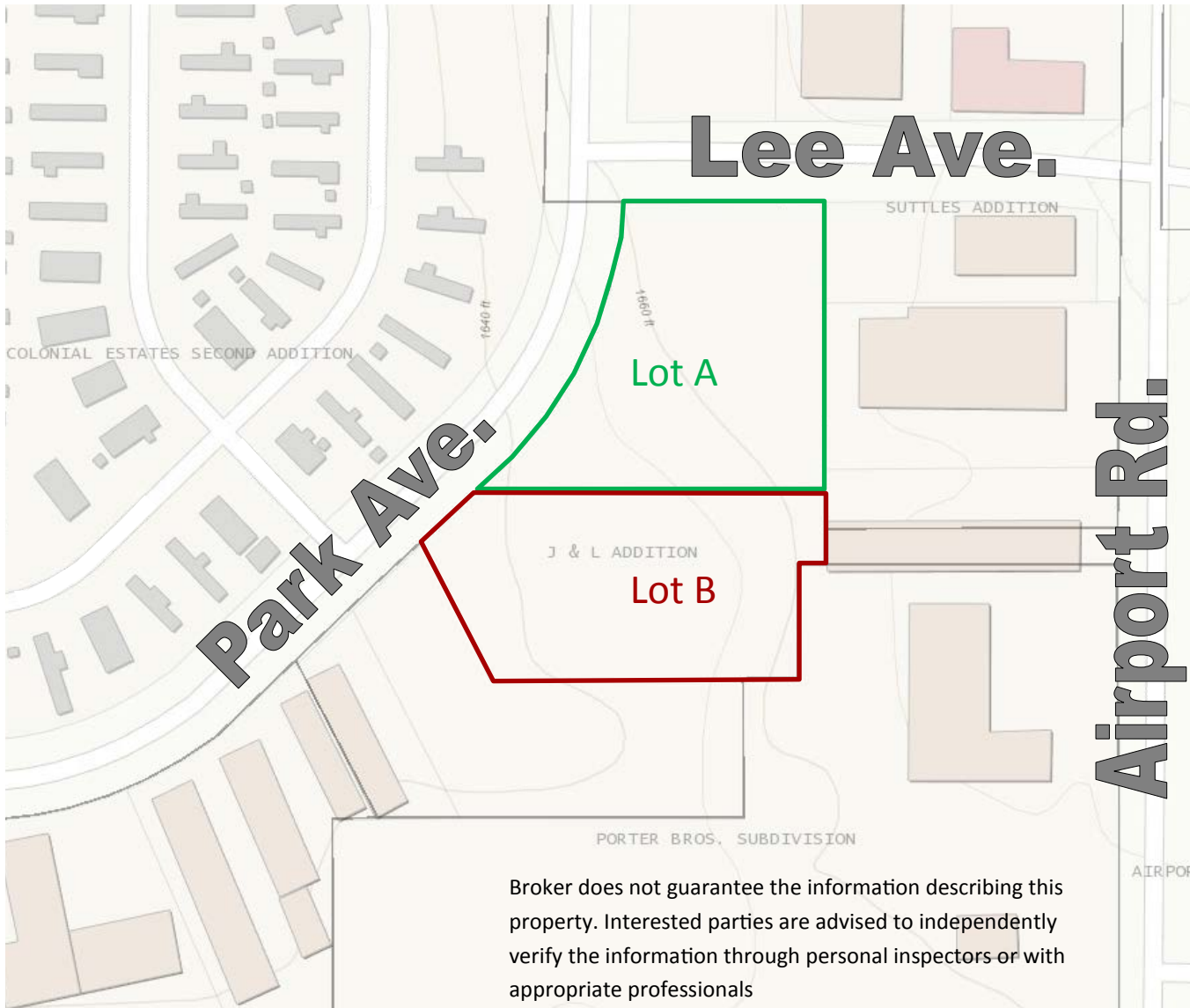

Lot A: \$396,960

- Lot Size: 66,716 sf - \$5.95 psf
- Zoned: MA Light Industrial

Lot B: \$222,468

- Lot Size: 74,156 - \$3.00 psf
- Zoned: MA Light Industrial

Potential Uses:

- Construction Business
- Retail / Showroom
- Service
- Wholesale Group
- Warehouse / Distribution
- Manufacturing
- Shop Condos
- Storage Facility



Taylor Daniel, Commercial REALTOR®
701.391.4262
Taylor@DanielCompanies.com

Bill Daniel, CCIM, Broker
701.220.2455
Bill@DanielCompanies.com

	Lot A	Lot B
Address	1825 Lee Ave - Bismarck, ND	1805 Park Ave - Bismarck, ND
Lot Size:	66,716	74,156
Lot Measurement:	(F) 199.69' x (AD) 298'	(F) 107.42 x (AD) 390'
Taxes:	\$2,719.79	\$3,134.68
Specials Balance:	\$10,531.40	\$12,548.86
Specials Installments:	\$2,144.11	\$2,491.90
Parcel ID:	1370-001-001	1370-001-050





DANIEL COMPANIES

The Leader in Commercial Real Estate

Serving commercial real estate clients with unmatched market knowledge, experience, and a well-deserved reputation for integrity. They know the Bismarck-Mandan commercial real estate market better than anyone. This powerful team delivers powerful results.



Bill Daniel, CCIM, Broker
701.220.2455
Bill@DanielCompanies.com



Kyle Holwagner, CCIM, SIOR
701.400.5373
Kyle@DanielCompanies.com



Taylor Daniel, Commercial REALTOR®
701.391.4262
Taylor@DanielCompanies.com

701.223.8488
304 E ROSSER AVE #200
BISMARCK, ND 58501



ICSC CCIM SIOR
INDIVIDUAL MEMBERS

RETAIL • INVESTMENTS • OFFICE • INDUSTRIAL • SITE SELECTION • LEASING • BUILD TO SUIT • BROKERAGE