

# South Bay Twin Home Lots



Taylor Daniel, Commercial REALTOR®  
701.391.4262  
[Taylor@DanielCompanies.com](mailto:Taylor@DanielCompanies.com)

Bill Daniel, CCIM, Broker  
701.220.2455  
[Bill@DanielCompanies.com](mailto:Bill@DanielCompanies.com)

[DanielCompanies.com](http://DanielCompanies.com)

# South Bay Phase Three - 2 Twin Home Lots

**7 SOLD**  
**8 SOLD**

**9 SOLD**  
**10 SOLD**

**11** 4212 Downing St.  
& 4216 Downing St.  
**12** 4304 Downing St.  
& 4306 Downing St.



“A resort atmosphere with a city address”. South Bay is one of Bismarck’s premier housing developments. These lots located on one of the largest man-made lakes in North Dakota, are zoned for twin home development (R10). South Bay is a spring fed private lake for the exclusive use of the homeowners and their guests. A private common beach area is available for swimming, fishing, and other water activities. These two home lots provide a great investment opportunity for home-builder, owner-users, developers, or investors. These lots also are adjacent to a private neighborhood park. This area has enjoyed great resale value. SOUTH BAY...A PEACEFUL PLACE TO COME HOME TO...RELAX & ENJOY THE GOOD LIFE!



## Executive Summary for SouthBay Lots 11

11

Parcel ID:	1558-004-005	1558-004-010
Address:	4212 Downing St.	4216 Downing St.
Lot Size:	5,332 SF	5,964 SF
Taxes 2018:	\$278.91	\$278.91
Specials:		
Balance -	\$9,619.35	\$10,049.27
Installment -	\$1,233.02	\$1,288.11

Broker does not guarantee the information describing this property. Interested parties are advised to independently verify the information through personal inspectors or with appropriate professionals.

## Executive Summary for SouthBay Lots 12

12

Parcel ID:	1558-004-015	1558-004-020
Address:	4304 Downing St.	4306 Downing St.
Lot Size:	7,095 SF	6,727 SF
Taxes 2018:	\$278.91	\$278.91
Specials:		
Balance -	\$12,338.90	\$11,538.32
Installment -	\$1,581.61	\$1,479.00

Broker does not guarantee the information describing this property. Interested parties are advised to independently verify the information through personal inspectors or with appropriate professionals.

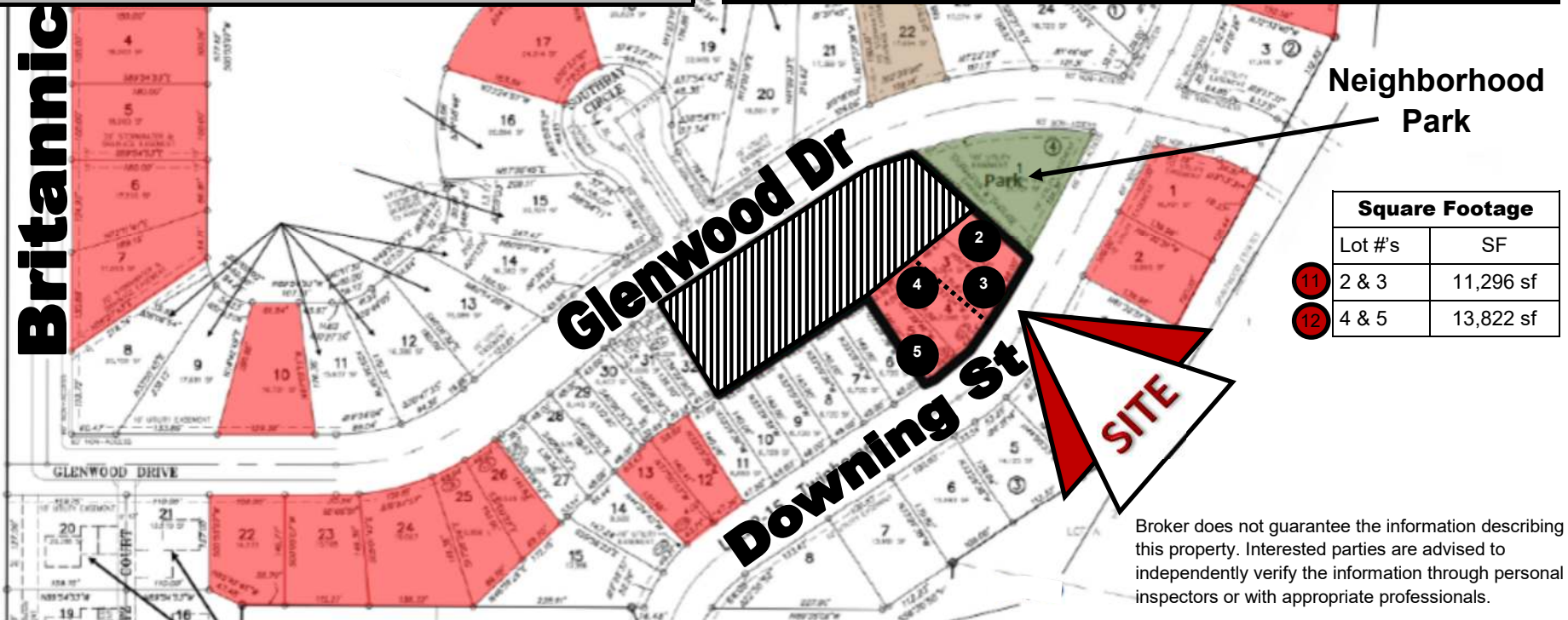

Broker does not guarantee the information describing this property. Interested parties are advised to independently verify the information through personal inspectors or with appropriate professionals.



Taylor Daniel, Commercial REALTOR®  
701.391.4262  
[Taylor@DanielCompanies.com](mailto:Taylor@DanielCompanies.com)

Bill Daniel, CCIM, Broker  
701.220.2455  
[Bill@DanielCompanies.com](mailto:Bill@DanielCompanies.com)



Concepts



**Taylor Daniel, Commercial REALTOR®**  
701.391.4262  
[Taylor@DanielCompanies.com](mailto:Taylor@DanielCompanies.com)

**Bill Daniel, CCIM, Broker**  
701.220.2455  
[Bill@DanielCompanies.com](mailto:Bill@DanielCompanies.com)

[DanielCompanies.com](http://DanielCompanies.com)



# DANIEL COMPANIES

The Leader in Commercial Real Estate



**Bill Daniel, CCIM | President  
Commercial Broker**

701.220.2455

Bill@DanielCompanies.com



**Taylor Daniel | Vice President  
Commercial Realtor®**

701.391.4262

Taylor@DanielCompanies.com

Serving commercial real estate clients with unmatched market knowledge, experience and a well-deserved reputation for integrity. They know the Bismarck-Mandan commercial real estate market better than anyone.

**Powerful Team. Powerful Process. Powerful Results.**