

# Industrial Shop

2021 Lee Ave

Bismarck, ND



**Kyle Holwagner, CCIM, SIOR**

701.400.5373

[Kyle@DanielCompanies.com](mailto:Kyle@DanielCompanies.com)

**Kristyn Steckler**

701.527.0138

[Kristyn@DanielCompanies.com](mailto:Kristyn@DanielCompanies.com)

[DanielCompanies.com](http://DanielCompanies.com)

50'

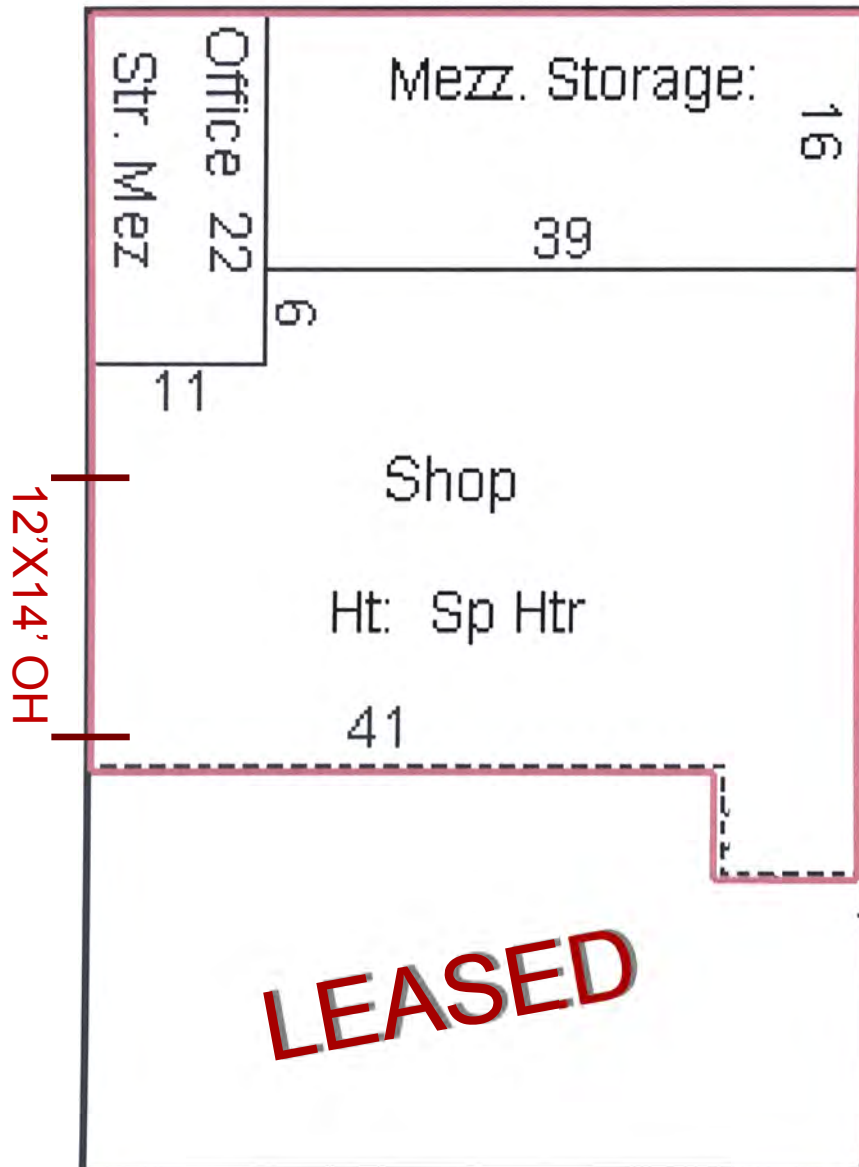

- **Lease Price: \$1,500 per month + Utilities**
- Lease Space: 2,500 sf Shop/Office + App. 9,000 sf Lot (Lot is currently shared area)
- 1,000 sf Mezzanine
- Fenced in Yard
- Easy Access
- Located in South Bismarck by Expressway and Airport Rd
- Available January 2018
- Earlier occupancy may be available
- 12' x 14' OH Door
- Small Office

### Storage Yard



# Aerial Photo



Kyle Holwagner, CCIM, SIOR  
701.400.5373  
[Kyle@DanielCompanies.com](mailto:Kyle@DanielCompanies.com)

Kristyn Steckler  
701.527.0138  
[Kristyn@DanielCompanies.com](mailto:Kristyn@DanielCompanies.com)

[DanielCompanies.com](http://DanielCompanies.com)



# DANIEL COMPANIES

The Leader in Commercial Real Estate

Serving commercial real estate clients with unmatched market knowledge, experience, and a well-deserved reputation for integrity. They know the Bismarck-Mandan commercial real estate market better than anyone. This powerful team delivers powerful results.



**Bill Daniel, CCIM, Broker**  
701.220.2455  
Bill@DanielCompanies.com



**Kyle Holwagner, CCIM, SIOR**  
701.400.5373  
Kyle@DanielCompanies.com



**Taylor Daniel, Commercial REALTOR®**  
701.391.4262  
Taylor@DanielCompanies.com

701.223.8488  
304 E ROSSER AVE #200  
BISMARCK, ND 58501



RETAIL • INVESTMENTS • OFFICE • INDUSTRIAL • SITE SELECTION • LEASING • BUILD TO SUIT • BROKERAGE