

Shop / Office Space

1815 Michigan Ave

Bismarck, ND



Kyle Holwagner, CCIM, SIOR

701.400.5373

Kyle@DanielCompanies.com

DanielCompanies.com



Price: \$310,000

- Building: 4,726 sf
- Land: 11,593 sf
- Office:
 - Natural gas fan-forced
 - Restroom
- Shop:
 - Natural Gas Unit Heaters
 - A/C
 - Not insulated
 - Expanded metal roof, post & beam
 - Floor Drain
 - Restroom
- Sound Proof Room
- 9' x 12' OH Door
- 14' Sidewalls
- 200 Amp, Single-Phase Panel
- 8" Block, Mason Structure
- Small fenced yard

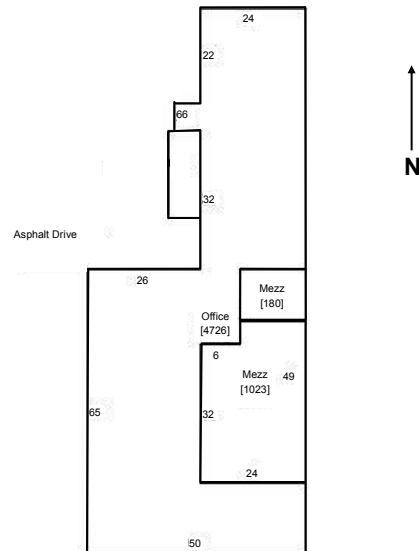

Broker does not guarantee the information describing this property. Interested parties are advised to independently verify the information through personal inspectors or with appropriate professionals.



Kyle Holwagner, CCIM, SIOR
 701.400.5373
Kyle@DanielCompanies.com

DanielCompanies.com

Area Businesses:

- Labor Finders
- Dakota Fire Station
- Pro-Tune Plus
- Montana Dakota Utilities
- SPS
- SuperValu Warehouse
- Family Dollar

Possible Uses:

- Manufacturing
- Warehouse
- Wholesale
- Construction
- Retail



Kyle Holwagner, CCIM, SIOR
701.400.5373
Kyle@DanielCompanies.com

DanielCompanies.com



DANIEL COMPANIES

The Leader in Commercial Real Estate

Serving commercial real estate clients with unmatched market knowledge, experience, and a well-deserved reputation for integrity. They know the Bismarck-Mandan commercial real estate market better than anyone. This powerful team delivers powerful results.



Bill Daniel, CCIM, Broker
701.220.2455
Bill@DanielCompanies.com



Kyle Holwagner, CCIM, SIOR
701.400.5373
Kyle@DanielCompanies.com



Taylor Daniel, Commercial REALTOR®
701.391.4262
Taylor@DanielCompanies.com

701.223.8488
304 E ROSSER AVE #200
BISMARCK, ND 58501



ICSC CCIM SIOR
INDIVIDUAL MEMBERS

RETAIL • INVESTMENTS • OFFICE • INDUSTRIAL • SITE SELECTION • LEASING • BUILD TO SUIT • BROKERAGE