

Available Office Space

1720 Sykes Dr. - Bismarck, ND
22,450 sf



Kyle Holwagner, CCIM, SIOR

701.400.5373

Kyle@DanielCompanies.com

DanielCompanies.com

Floor Plan

EXHIBIT A

Remaining Area
Suite 101
22,450 RSF

Building
Common
Area

Sublet Premises
Suite 102
19,550 RSF

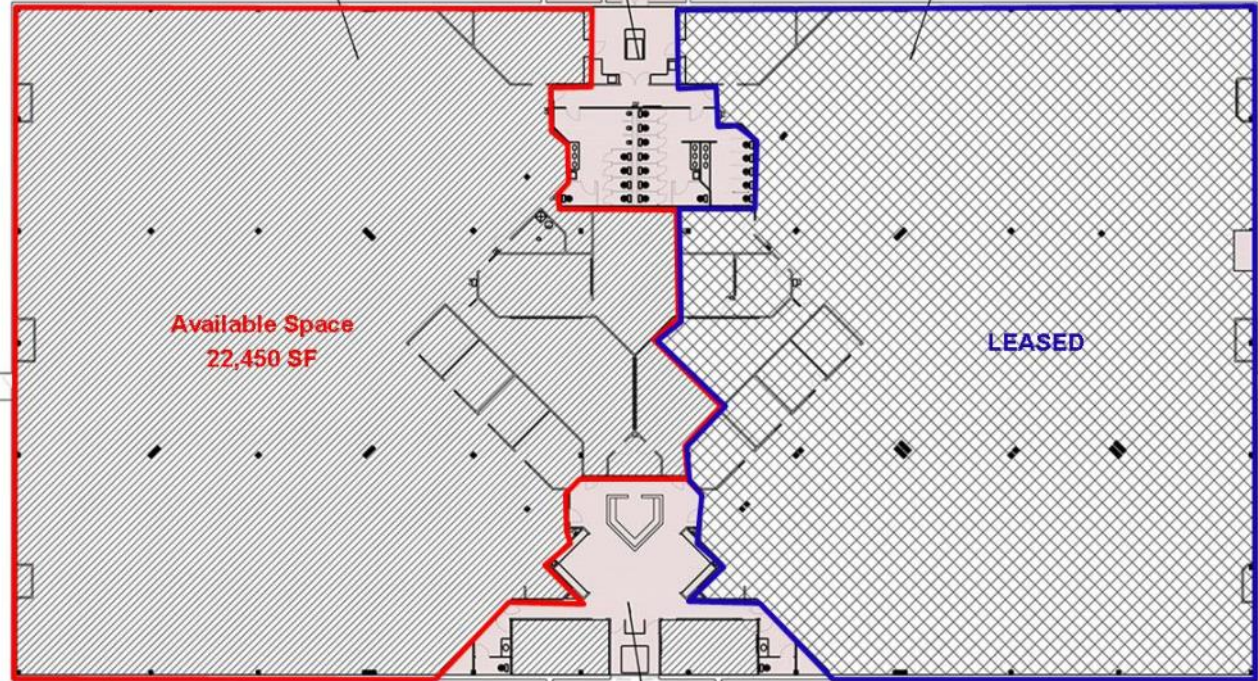

FLOOR - 01
AETNA - 1720 Sykes Street, Bismarck ND

aetna

Building
Common
Area

Aetna Real Estate Services

December 18, 2014
NOT TO SCALE

**Sublease: \$8.50 Base +
est. \$5.70 Operating
Expense (\$14.20 psf)**

- Lease Space: 22,450 sf
- Lot Size: 8.26 Acres
- Multi-zones Heating & Cooling
- Off Street Parking
- ADA Restrooms in Building
- Open Floor Plan
- Server Room

Broker does not guarantee the information describing this property. Interested parties are advised to independently verify the information through personal inspectors or with appropriate professionals.



Kyle Holwagner, CCIM, SIOR
701.400.5373
Kyle@DanielCompanies.com

DanielCompanies.com



Kyle Holwagner, CCIM, SIOR
701.400.5373
Kyle@DanielCompanies.com

DanielCompanies.com



DANIEL COMPANIES

The Leader in Commercial Real Estate

Serving commercial real estate clients with unmatched market knowledge, experience, and a well-deserved reputation for integrity. They know the Bismarck-Mandan commercial real estate market better than anyone. This powerful team delivers powerful results.



Bill Daniel, CCIM, Broker
701.220.2455
Bill@DanielCompanies.com



Kyle Holwagner, CCIM, SIOR
701.400.5373
Kyle@DanielCompanies.com



Taylor Daniel, Commercial REALTOR®
701.391.4262
Taylor@DanielCompanies.com

701.223.8488
304 E ROSSER AVE #200
BISMARCK, ND 58501



ICSC CCIM SIOR
INDIVIDUAL MEMBERS

RETAIL • INVESTMENTS • OFFICE • INDUSTRIAL • SITE SELECTION • LEASING • BUILD TO SUIT • BROKERAGE