

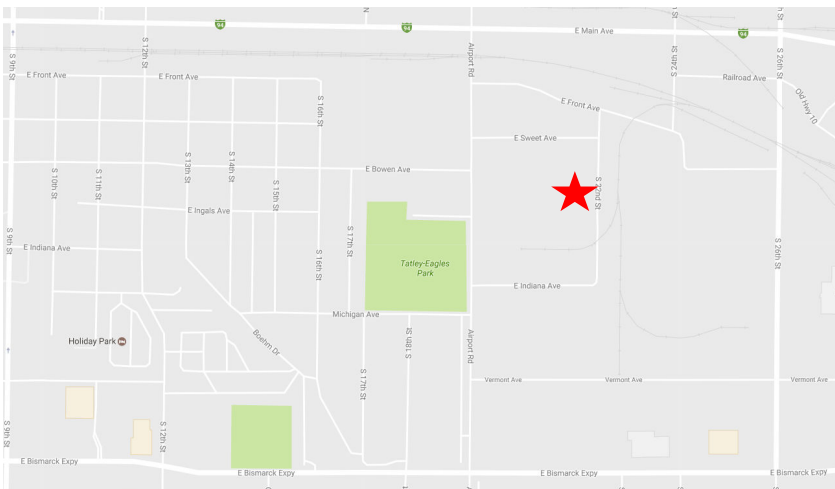

- Lease Rate: \$8.50 psf NNN
- Building Size: 9,450 sf
6,810 sf - Warehouse
2,640 sf - Office/Retail w/
Mezzanine
- Lot Size: 54,431 sf / 1.25 ac
- (2) 12'x14' OH Doors;
10'x8' Loading Dock Door
- 16' Ceiling Height
- Zoned: MA-Light Industrial
- Ample Parking
- 3 Phase Power
- Outside Storage



INDUSTRIAL WAREHOUSE/SHOP
410 S. 22nd St - Bismarck ND

Contact Information:

Kyle Holwagner, CCIM, SIOR
701.400.5373
Kyle@DanielCompanies.com

Daniel Companies
304 E Rosser Ave Suite 200
Bismarck ND 58501
701.223.8488 | 701.223.8860 fax

Broker does not guarantee the information describing this property. Interested parties are advised to independently verify the information through personal inspectors or with appropriate professionals.

DanielCompanies.com